



# BLACK UNICORN CAPITAL

## SHOPPING MADE EASIER

Developing Oodi's first convenience & lifestyle centre. The Development will bring together a diverse mix of businesses providing a one-stop retail location opposed to the current scattering of small retailers.

Oodi Mall will occupy a prime position along the Oodi- Modipane road. The location is easily accessible from the rapidly expanding residential areas in Oodi and from Modipane, Ruretse as well as Matebeleng.

There are a variety of unit sizes on offer, offering flexible retail space which can be customised to meet tenant requirements. Completion is expected in the 1st quarter of 2020.

**SECURE YOUR SPACE TODAY**

# THE OPPORTUNITY

## LOCATION

The site is ideally situated in Oodi village along the Oodi-Modipane tarred road, directly opposite the Oodi College of Applied Arts and Technology with easy access to surrounding villages of Modipane, Ruretse and Matebeleng.

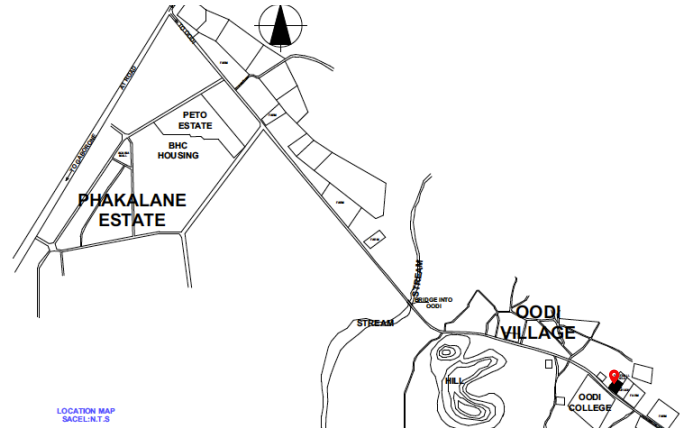
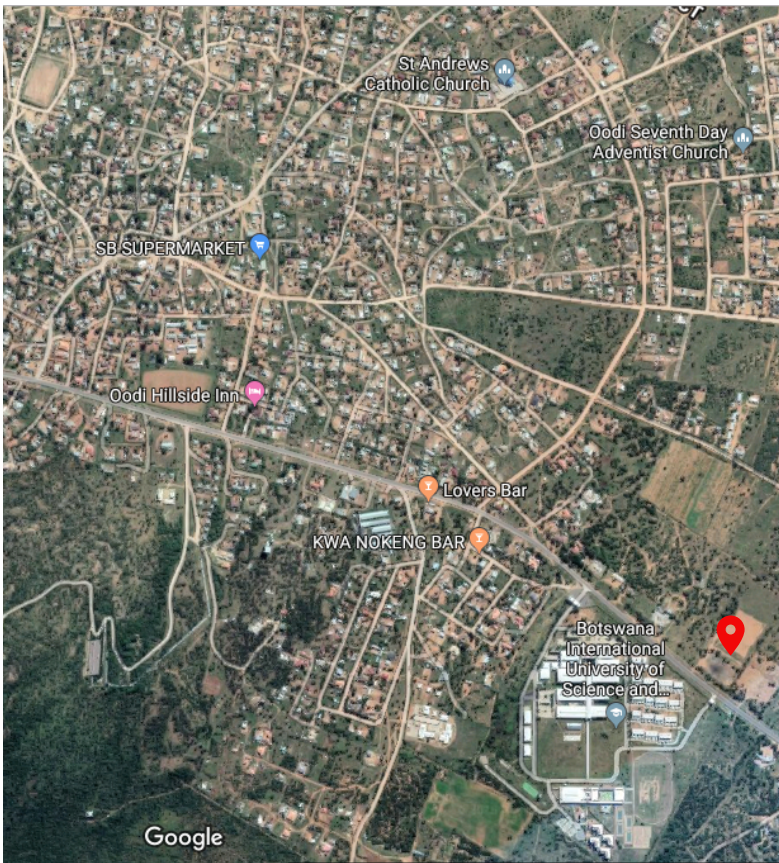

## MARKET

The catchment area has a population of over 15,000 people recorded for Oodi, Modipane and Matebeleng and with currently no modern shopping centre to service this rapidly growing population.

This presents as the ideal investment opportunity.



## OUR PARTNERS

We have partnered with Dow & Associates and Belshane Property Group to offer leasing and property management services to ensure that our customers/tenants receive the highest quality services.



# THE ARCHITECTURAL DESIGN

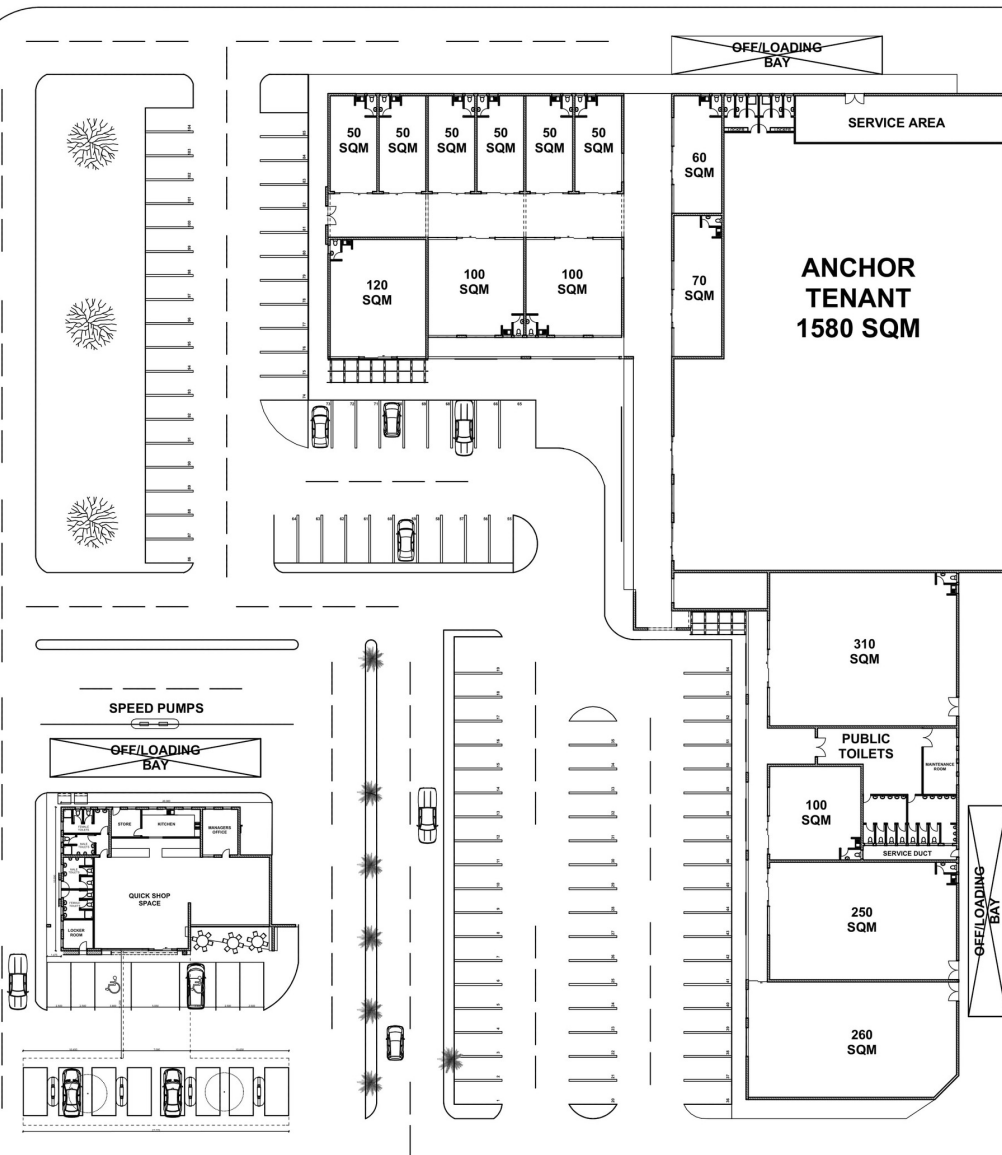

**Contact us to discuss this opportunity today!**

Tumisang Dow  
+267 76406238  
tumisang@dow.co.bw

Mr. Olebeng Ngwakwena  
+267 3919356  
+267 73001718  
olebeng@belshane.com

[www.oodimall.co.bw](http://www.oodimall.co.bw)